

What is needed to light a bulb?

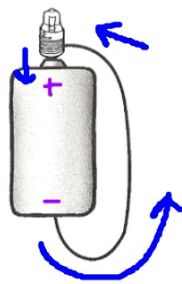

A wire, energy source and receiver is needed to light a lightbulb. Electricity flows from the negative to the electric receiver (bulb) and back to the positive. More energy leaves the negative and less returns to the positive.

What does energy do in a circuit with a motor?

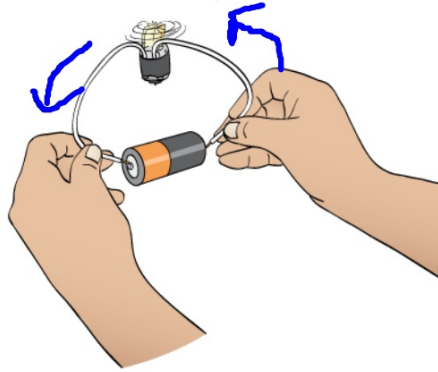

A motor is an energy receiver that produces motion. A switch is a device that opens and closes a circuit. A closed circuit allows electricity to flow.

What materials are conductors or insulators?



All metals are conductors. Conductors allow electricity to flow through them. Insulators are non metals. We used the motor to show if an object was a conductor.